



**SwiftGo** 

*Wherever you want*

*Lightweight patient  
hoists for mobility,  
safety & support*

by **SwiftTech**<sup>™</sup>  
*Raising the standard*



Wherever you want

### The Swift Lifter™ Our lightweight, portable, folding hoist

- Lifts from bed, chair, floor etc.
- 21 stone weight capacity (135kg)
- Unique folding and transportable design
- Dual speed
- Large sling range available
- Carry bag kit (optional)
- New colours available

Designed essentially to be used by community carers, the Swift Lifter™ has great functionality and affords the solution to many patient lifting situations.

The Swift Lifter's quality aluminium structure, whilst being built to exceed British and European standards, results in a lightweight, very manoeuvrable mobile hoist system.

The Swift Lifter™ can be used by one carer to carry out a variety of patient transfers i.e. floor to bed, chair to commode, chair to bed or wheelchair to bath etc.

The Swift Lifter™ is complemented by the SwiftTech™ range of slings which ensure maximum patient safety, comfort and support.

The Swift Lifter™ is easy to transport as it's modular construction allows for quick disassembly, even into the boot of a small car and can be reassembled at the patient's home or on holiday etc.

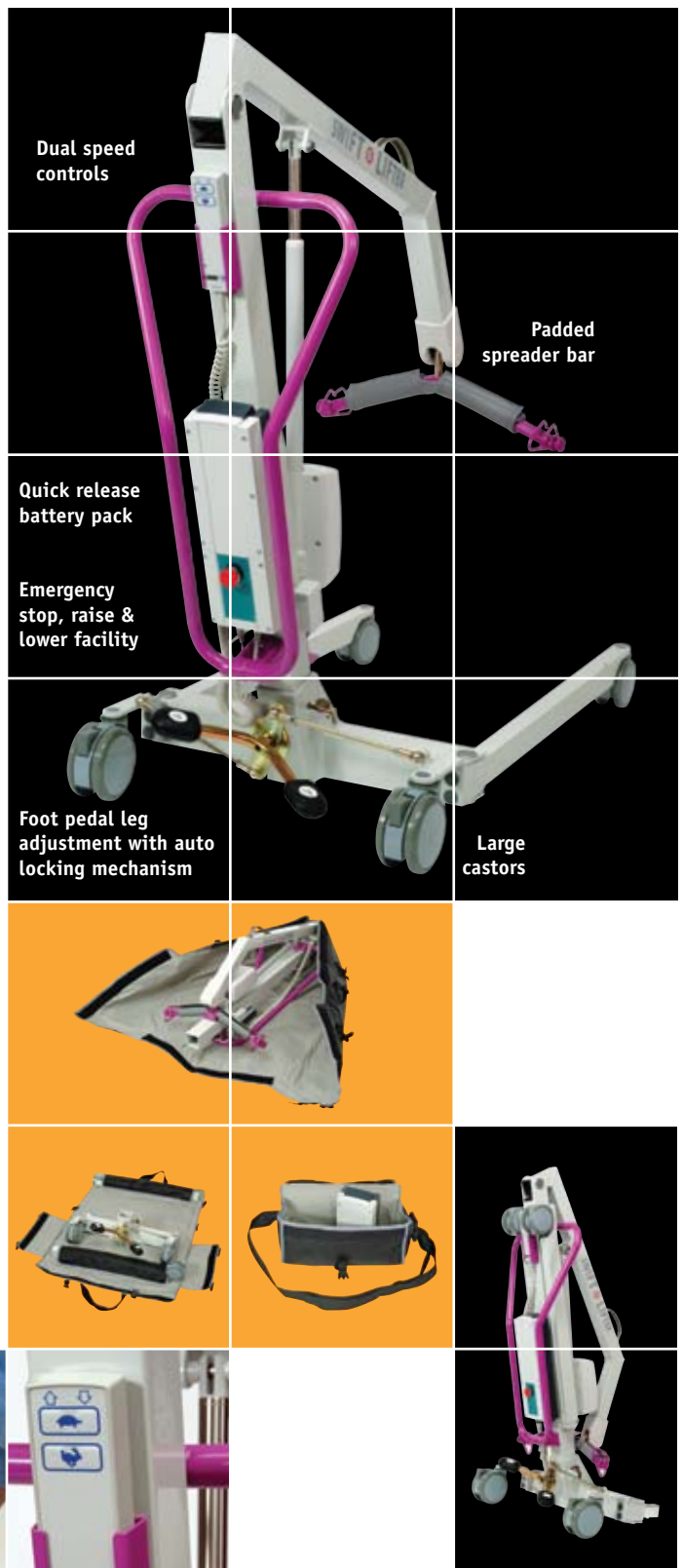

Contact our sales team direct for further details or a competitive quote

**01225 792 650**  
**info@swifttechhoists.co.uk**  
**www.swifttechhoists.co.uk**

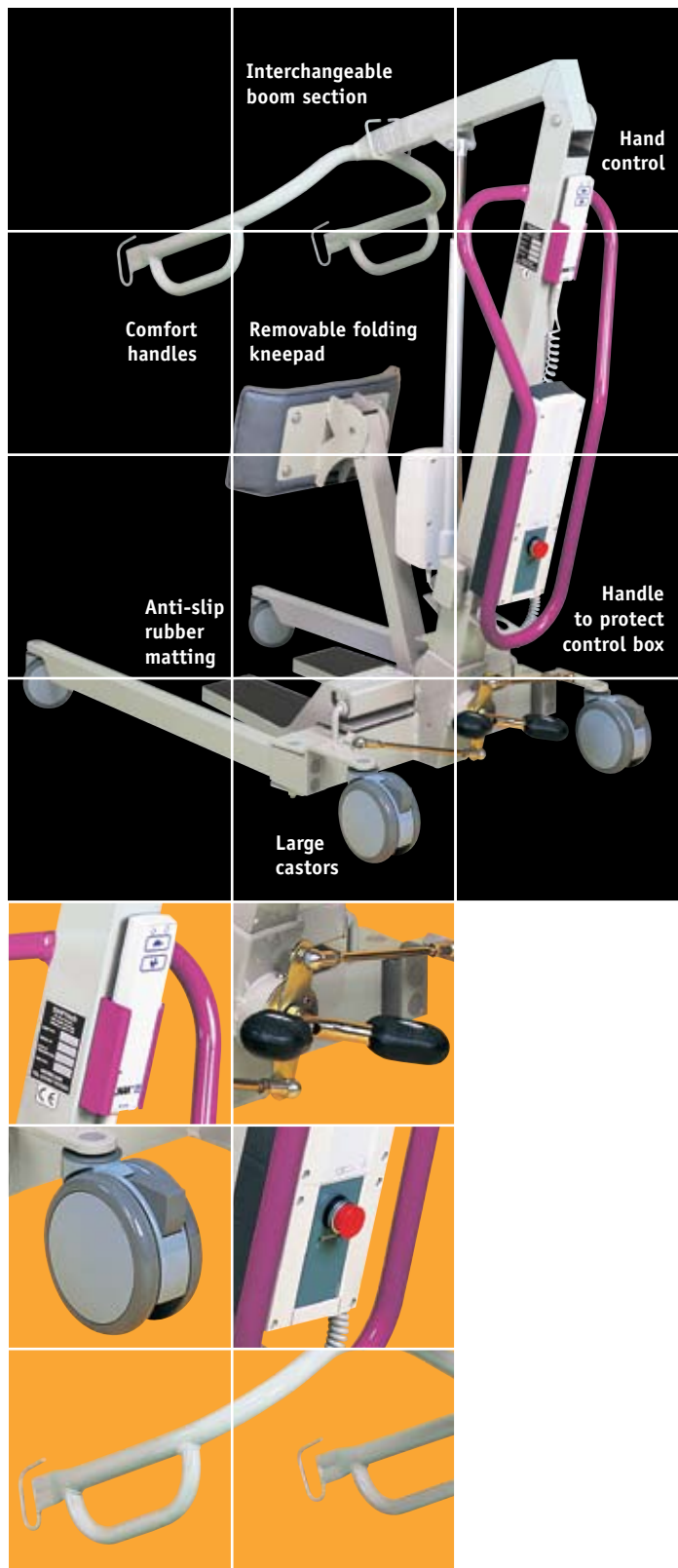

## *The Swift Combi™ Introduces a new dimension for community carers*

- No tools required
- Can be used with 3 types of sling
- Foldable to enable storage
- When disassembled it can be transported in the boot of a small car
- The weight of the largest component is less than 10kgs

There is now no need for two pieces of equipment. The Swift Combi™ will enable carers to carry out both standing and lifting transfers with one hoist. The Swift Combi™ can be changed from a Stander to a Lifter in minutes, without the use of tools. Foot supports, boom section and kneepad can be quickly removed and the Swift Lifter Boom attached.

The Swift Combi™ Stander is used with three types of sling, i.e. the basic Stander Sling, which does require the patient to have some standing ability and upper body strength, the Comfort Stander Sling, which requires slightly less standing ability and includes a velcro chest band for additional security, or the Transfer Sling for which the patient requires no standing ability as the sling offers additional support and is especially used for transfers where clothing adjustments are not required.

The Swift Combi™ Lifter is needed where more support is required and is used with the range of full body slings.

In addition, the Swift Combi™ will fold to enable storage in the most confined spaces and it's modular design and carry bag kit allows the hoist to be disassembled and transported in the boot of a small car. The weight of the largest component is less than 10kgs!

The Swift Combi™ from SwiftTech™ is the ultimate transportable combination lifter.

An approved **NHS** supplier

**SwiftGo**  
Wherever you want

by **SwiftTech**  
Raising the standard

## Technical information

Description	Swift Lifter™	Swift Combi™
Total weight	26.3kg	35.2kg
Weight of chassis	9.0kg	9.9kg
Weight of legs (x2)	2.9kg	2.9kg
Weight of battery	2.85kg	2.85kg
Weight of mast & boom assembly	11.55kg	9.95kg
Weight of kneepad assembly	N/A	2.8kg
Weight of foot supports (x2)	N/A	3.92kg
Weight of detachable stander boom	N/A	2.90kg
Weight of detachable lifter boom with spreader bar	N/A	2.60kg
Maximum spreader bar height	1630mm	1850mm
Typical dimensions under sling Lifter only	875mm	875mm
Overall width	625mm	625mm
Overall length assembled	1130mm	1130mm
Overall length stored	470mm	470mm
Overall height	1190mm	1190mm
Chassis height standard castors	116mm	116mm
Internal leg width minimum	530mm	530mm
Internal leg width maximum	940mm	940mm
Maximum safe working load	135kg (21st)	135kg (21st)



We believe that anyone who requires special care deserves the best care. Our mission is to provide and maintain the latest innovations to aid disabled people in their environment. Our products and services (beyond the mobile systems shown in this brochure) provide solutions whatever the application and can be found in the following additional ranges. Please call for a brochure and find out how we can get your project moving.



Design, supply & installation of ceiling hoist systems



Providing bathroom facilities for people with disabilities



Servicing & maintenance solutions for all care environments



Patient slings & harness systems



Privacy screens & curtains for all care environments

**01225 792 650**  
**info@swifttechhoists.co.uk**  
**www.swifttechhoists.co.uk**

#### Head Office

#### SwiftTech™

Orion House, 10 Hercules Way,  
 Bowerhill Industrial Estate,  
 Melksham, Wiltshire SN12 6TS  
 Telephone: 01225 792 650  
 Fax: 01225 792 659

Website: [www.swifttechhoists.co.uk](http://www.swifttechhoists.co.uk)  
 Email: [info@swifttechhoists.co.uk](mailto:info@swifttechhoists.co.uk)

An ISO 9001 Registered Firm